



Mayflower Business Park Office/Flex

428 - 438 Court St. Plymouth MA

FOR LEASE



Google Earth

©2018 Google

300 ft



Google

CENTER INFORMATION

- Location:** Route 3A Plymouth/Kingston Town Line
- Parcel Size:** 16+ Acres
- Center GLA:** 52,000 SF
- Primary Zoning:** (NC) Neighborhood Commercial Ply (R20) Kingston
- Traffic Count:** 17,820 AADT (Court St. Route 3A)
- Pylon Signage on Route 3A**
- Loading docks in rear**
- 1 mile from Route 3 Exit 8**
- Close to Cordage Park Complex**
- Nearby MBTA Commuter Rail Station**
- Available: 15,000 SF Storage Space**

No warranty or representation, express or implied, is made as to the accuracy of the information contained herein, and same is submitted subject to errors, omissions, changes of price, lease, terms or other conditions and/or withdrawals without notice. All information must be verified by interested parties.



Mark Sobel
msobel@1stusrealty.com
508.280.4563
508.591.3000

www.1stusrealty.com



Mayflower Business Park

428 - 438 Court St. Plymouth MA

Office/Flex
FOR LEASE

CENTER LAYOUT

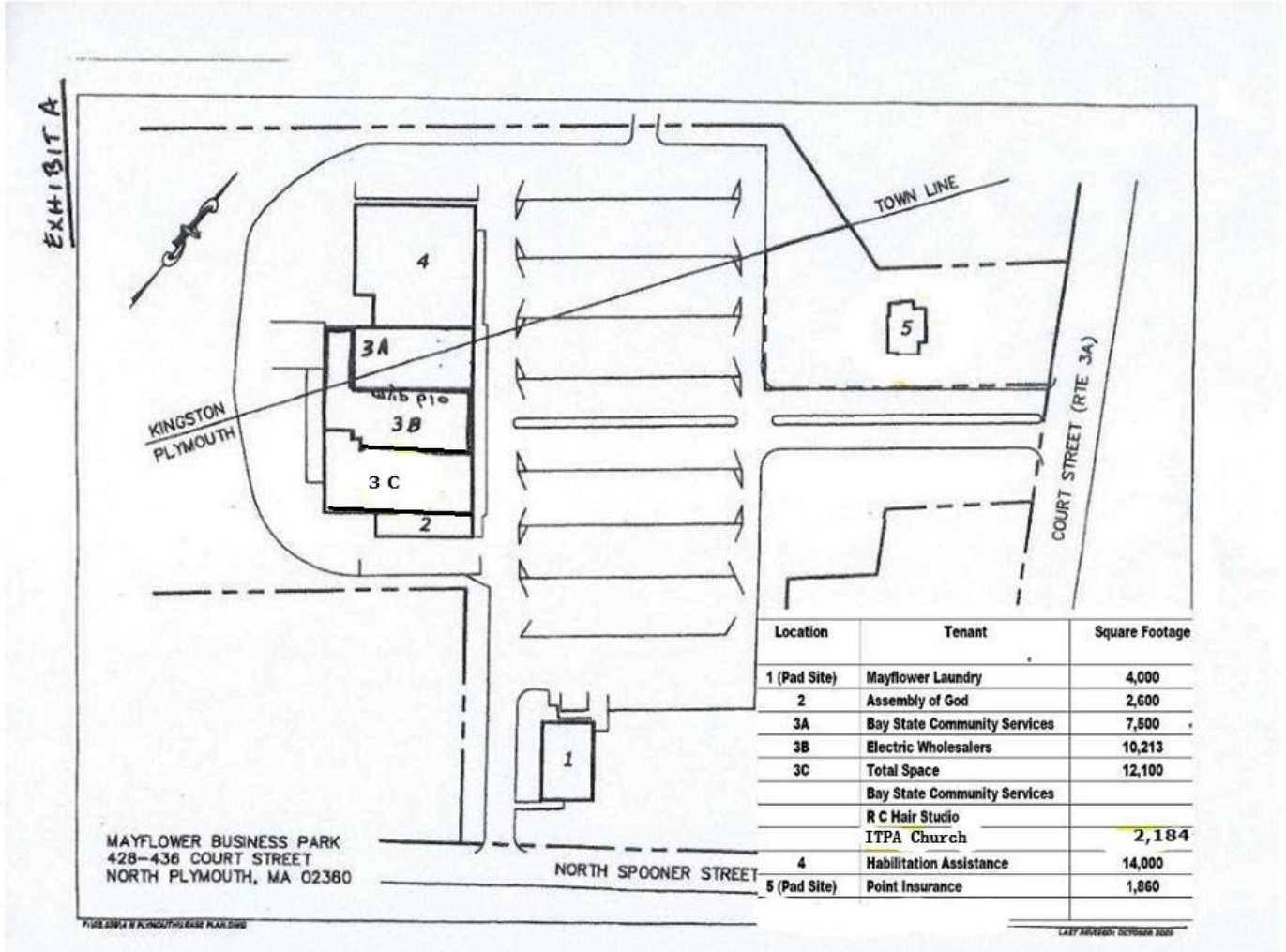

No warranty or representation, express or implied, is made as to the accuracy of the information contained herein, and same is submitted subject to errors, omissions, changes of price, lease, terms or other conditions and/or withdrawals without notice. All information must be verified by interested parties.



Mark Sobel
msobel@1stusrealty.com
 508.280.4563
 508.591.3000

www.1stusrealty.com

Mayflower Business Park

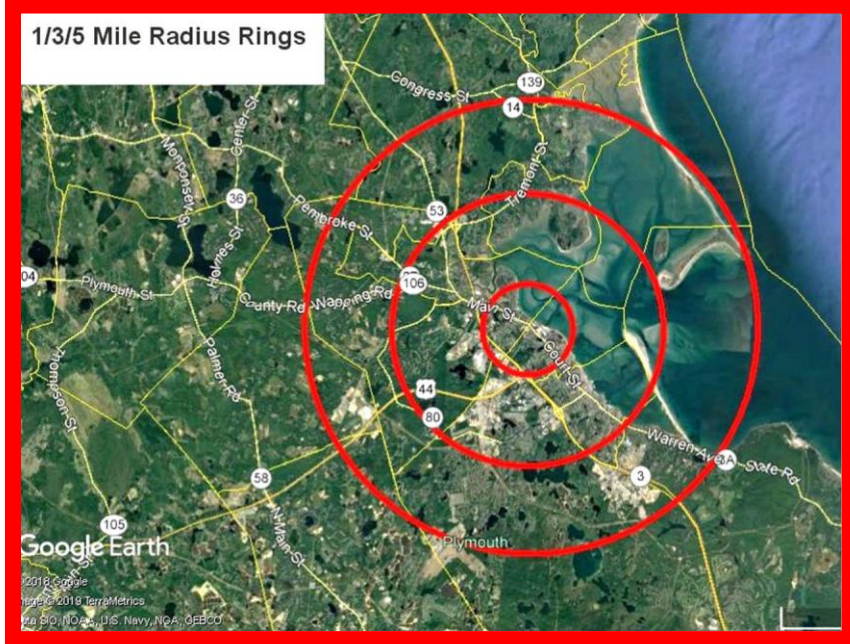

DEMOGRAPHICS

Radius	Population	Med. HH Income	# Households
1 Mile	4,577	\$66,651.	1,968
3 Miles	24,868	\$69,857.	10,396
5 Miles	50,950	\$88,232.	19,337



AVAILABLE FOR LEASE

Up to 15,000 SF Storage Space

No warranty or representation, express or implied, is made as to the accuracy of the information contained herein, and same is submitted subject to errors, omissions, changes of price, lease, terms or other conditions and/or withdrawals without notice. All information must be verified by interested parties.



Mark Sobel
msobel@1stusrealty.com
508.280.4563
508.591.3000

www.1stusrealty.com